



[11000 Stockdale St.](https://www.FishersEventCenter.com)
[Fishers, IN 46037](https://www.FishersEventCenter.com)
www.FishersEventCenter.com

TECHNICAL PACKET

Last Update: 7/29/25



Fishers Event Center
11000 Stockdale St., Fishers, IN 46037
Phone Number 463.244.2224
www.FishersEventCenter.com

Fishers Event Center is Indiana's new home created in November of 2024 for premier entertainment in the Midwest. The state-of-the-art venue with a seating capacity of 7,500 pairs high quality entertainment with an intimate setting to provide an unmatched fan experience. Located just 20 minutes northeast of downtown Indianapolis, the 53-acre site expands on the recently developed 18-acre Fishers District, part of the \$1.1 billion in economic and entertainment investments within the City of Fishers.

PRODUCTION GUIDE

Table of Contents	Page 2.
Contact Information	Page 3
- Facility	Page 3
- Directory	Page 3
Production Information	Page 4
- Directions	Page 4
- Loading Dock	Page 4
- Stagehands & Production Labor	Page 5
- Curtains & Seat Covers	Page 5
- Audio & Visual	Page 5
- Locker Rooms & Dressing Rooms	Page 6
Technical Information	Page 7
- Building Specifications	Page 7
- Equipment & Rentals	Page 7
- Rigging	Page 8
- Electrical	Page 8
- Special Effects	Page 8
- Lighting	Page 9
- Other Event Center Configurations	Page 9
- Additional Equipment	Page 9
Catering	Page 10
- House Catering	Page 10
- In-House Catering	Page 10
Building Information	Page 10
- Ticket Office (Box Office)	Page 10
- Merchandise & Sponsorship	Page 10
Safety & Security	Page 11
- Building Security	Page 11
- Crowd Management Staffing	Page 11
- Medical Staffing	Page 11
- Hospitals	Page 11
- Emergency Management	Page 11
Hotels/Lodging/Travel & Food	Page 12
- Hotels	Page 12
- Food	Page 13
- Transportation	Page 13
Facility Maps	Page 14
- Event Level Map	Page 14

CONTACT INFORMATION

Facility

Mailing Address: 11000 Stockdale Street, Fishers, IN 46037

Main Office Phone: 463.244.2224

Website: <https://fisherseventcenter.com/>

Directory

Executive

General Manager – Mitch List / mlist@ASMFishers.com / 865-659-9899

Assistant General Manager – Chris Whittemore / cwhittemore@ASMFishers.com / 814-777-3580

Director of Booking – Bill Kelley / bkelly@ASMFishers.com / 463-202-3022

Director of Sales – Caroline Myers / cmyers@ASMFishers.com / 317-339-8371

Event Services

Event Manager – Ryan Hague / rhague@ASMFishers.com / 317-391-1178

Operations Manager – Drew Lundquist / dlundquist@ASMFishers.com / 515-339-4174

Event Security & Guest Relations Manager – Andy King / aking@ASMFishers.com / 317-509-6045

Production Manager – Brian McRoy / bmcroy@asmfishers.com / 615.489.7228

Building Administration

Director of Finance – Tony Hesch / ahesch@ASMFishers.com / 317-460-5324

Director of Marketing – Anne Clendenin / aclendenin@ASMFishers.com / 317-476-3511

Box Office Manager – Kristi Armstrong / karmstrong@ASMFishers.com / N/A

Director of Food & Beverage – Josh Vaught / jvaught@ASMFishers.com / 317-719-4116

Director of Marketing - Anne Clendenin / aclendenin@asmfishers.com / 317-476.3511

Local Administration

Fire Marshall – Adam Newsom – newsomj@fishers.in.us – 317.595.3178.

Merchandise – Please contact your Event Contact.

PRODUCTION INFORMATION

DIRECTIONS

From the North

- Go South on I-69 and take Exit 204. Travel East on 106th St and go North on USA Parkway, then travel East on USA Drive.

From the East

- Travel West on 106th St and head North on USA Parkway.
- Travel West on 116th St and head South on USA Parkway.

From the West

- Travel East on 106th St and head North on USA Parkway.
- Travel East on 116th St and head South on USA Parkway.

From the South

- Go North on I-69 and Take Exit 204. Travel East on 106th St and North on USA Parkway, then travel East on USA Drive.

LOADING DOCK

The Fishers Event Center's loading dock is located on the South end of the area. Once you are driving on USA Dr you will follow the edge of the building until you get to the backside. There you will see our loading dock and be able to take a left-handed turn into our gated loading dock.

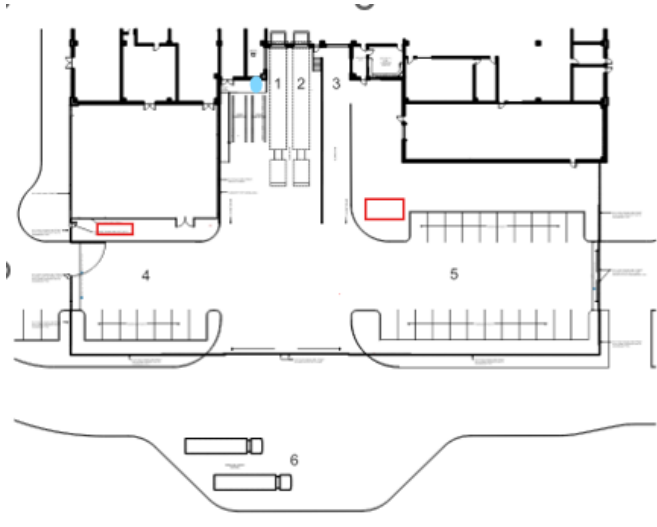

Truck Parking Layout

Fishers Event Center has the capability to unload two to three trucks at a time. There are two loading docks with levelers (1 & 2). In spaces 4 & 5 we had additional parking inside the loading dock for Trucks and Busses. Number 6 is an example of our overflow parking.

Shore Power / Water Hook-Ups

5 on shore connections power – Red Square

Water Hook up is located at the Blue Dot.

Docks

Two Docks with leveler plates, 8' w x 10' h overhead doors.

One additional spot for truck to back into venue and unload with ramp or fork, 12' w x 14' h overhead door.

93' foot push to upstage edge through 12' w x 14' h interior overhead door.

Public Parking

2,000+ parking spaces plus additional spaces within the Fishers District.

STAGEHANDS & PRODUCTION LABOR

STAGEHANDS

Fishers Event Center is a Union labor building for production. For scheduling, rates, or questions, please contact your Fishers Event Center event production contact. *Note: Houselights Operator will need to be on the Union show call.

HOUSE OPERATIONS

For BOH tables and chairs please contact your Event Manager, along with any other set up needs possible.

ADDITIONAL PRODUCTION LABOR

Runners, VIP Assistants

CURTAINS & SEAT COVERS

UPSTAGE BACKDROP CURTAIN

Fishers Event Center can provide a 120' W by 40' H Back Curtain to along the whole back side of the stage.

SEAT COVERS

Fishers Event Center does not have any seat covers on site. If you would like to request seat covers. The show will need to provide the seat kill covers and schedule hands from the Union to install the seat covers.

AUDIO & VISUAL

Communications

- Green Go Digital and Clear Com Intercom System
- 2 Wire System
- 2 Channels
- 1 Base System
- 10 Hard Wired Belt Packs Clear Com
- 8 Wireless Belt Packs Green Go

House Sound

- Internal house PA system is available to use and patch into

TV Broadcasting - Will have the capability to broadcast live events and games to traditional cable networks and streaming.

Ribbon Board

The digital signage display at Fishers Event Center consists of a single display Jumbotron with a ribbon video wall running parallel with the arena floor. For more information, please contact your Fishers Event Center event contact for more details. This is outsourced and will require prior advancement for operators and content.

- Video Display Dimension East Side: 142' – 8 13/16" w x 2' 5 1/2" h
- Video Display Dimension West Side: 152' – 6 5/16" w x 2' 5 1/2" h

Outdoor Marquee

Video Display Dimension: 44' 8 3/4" w x 25' 6 5/16" h

Third Party Operator

Tupelo Honey

- Please get with your Event Contact regarding these services and needs.

Scoreboard

- Center hung, fully retractable.
- Video Display Dimensions: 28'5" w x 16' h
- (4 video displays)

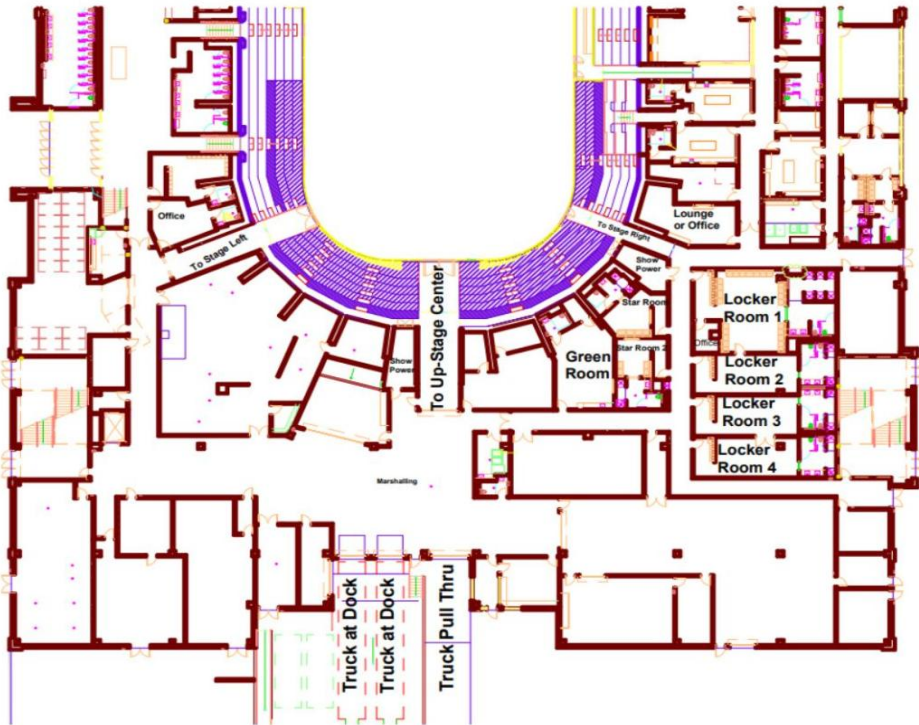

Internet & Phone Access

- Internet Line / Included

Hospitality Items/ Get in touch with your Event Manager – Additional Costs Involved

- Furniture – Couch, Loveseat, & Coffee Tables

○ (\$150/set)

- Towels - Black Hand & Black Bath

○ (\$1.50/towel)

- Runners

○ Half Day Rate 1-6 hrs - \$150

○ Full Day Rate 7-15 hrs - \$300

.....

Location	Furniture	Size	Showers (#)	Restrooms	TV	Notes	Common Use
Lounge	Lounge Seating	13' X 33'	-	-	Yes		
Star Room 1	-	13' X 11'	Yes (1)	Yes (1)	Yes	Private	
Star Room 2	-	12' X 17'	Yes (1)	Yes (1)	Yes	Private	
Green Room	Lounge Seating	30' X 19'	No	Yes (1)	Yes	Private	
Locker Room 1	Lockers	26' X 20'	Yes (6)	Yes (2)	TBD	*Has Private Office	
Locker Room 2	Shelves & Hooks	22' X 11'	Yes (2)	Yes (2)	TBD		
Locker Room 3	Shelves & Hooks	24' X 13'	Yes (2)	Yes (2)	TBD		
Locker Room 4	Shelves & Hooks	24' X 13'	Yes (2)	Yes (2)	TBD		
Office	-	22' X 11'	No	Yes (1)	TBD	Private/with a Door to Public	

Washer and Dryer

There is a washer and dryer onsite. We do use them for Mops and cleaning supplies so please let us know if you would like to use them and we can prepare them for you to use.

TECHNICAL INFORMATION

BUILDING SPECIFICATIONS

Event Floor

- Weight Limit
- 200' X 85' Hockey Rink; 219' X 85' with Risers retracted and ice out.

Push Distance from Loading Dock to the Arena Floor.

- 75'feet; The arena floor is on the same level as the loading docks.

Service Elevator

Elevator #2 – Large Service

- o Weight Limit: 5,000 lb.
- o Dimensions: 5'5" X 8'8" X 9' Tall
- o Access Door Dimensions: 4' X 8'

Elevator 1 & 3 – Small VIP 1 / Small Public 3

- o Weight Limit: 2,500lb
- o Dimensions: 4'5" X 6'6" X 9' Tall
- o Access Door Dimensions: 3'6" X 8'

House Light System

- All house lighting is controlled from the lighting booth behind the Back House Curtain.

EQUIPMENT & RENTALS

The following equipment is available upon request in-house at Fishers Event Center or a third-party rental. Please contact the Fishers Event Center contact for additional information on equipment.

Stage:

Stage Right (ME-3750) Rolling Stage System

Decks: 4' X 8' (Reversible with Black TechStage with Anodized Edge's)

Height: 4' to 6' at 2" Increments

Maximum Stage Size: 60' X 48' (No Stage Wings)

Maximum Thrust Size: 52' X 8'

Stage Accessories:

Barricade: Stage Right CC-500 4' Wide (100' ft)

Stairs: (5) Sets

Stage Skirting: Yes (How Many Feet)

Stage Equipment:

Risers/Platforms: 6' X 8' Risers (Adjustable 1' to 2')

Camera Platforms: 4' X 8' (Stage Decks & Legs)

Pipe & Drape: 8' Tall (200' ft)

Miscellaneous: Bike Rack & Stanchions

In – House Equipment

- (1) 5k Forklift /\$200 per fork and labor.
- (4) Pallet Jacks
 - o (2) Motorized
 - o (2) Manual

Outsourced Rental Equipment

- Forklift
- Runner Vehicles
- SFX Gas

Tables & Chairs

- 8'ft Tables / (15) Total
- 6'ft Tables / (30) Total
- Rounds / (20) Total
- Chairs / Can be given upon request. (1,900) Total

****Note** – If you need more Tables then we can provide, please get in contact with your Fishers Event Center event contact.



RIGGING

All rigging must be approved through Fishers Event Center Contact. Fishers Event center is a Union Labor building for Production needs.

Floor to Low Steel – 50’ft

MAX Rigging Weight – 125,000 (For End Stage)

For more rigging information please click the links down below.

[Rigging Link](#)

[Rigging Overlay Example](#)

ELECTRICAL

Show Power

Location/Power	Up-Stage Center	Stage Right	Behind FOH	Rigging Grid Catwalk
400-Amp, 3-Phase, Cam Locks	(2)	(1)	-	-
200-Amp, 3-Phase, Cam Locks	(2)	(1)	-	-
175-Amp, 3-Phase, Cam Locks	-	-	(1)	-
100-Amp, 3-Phase, Cam Locks	(1)	(1)	-	(1)

SPECIAL EFFECTS

NOTE: Special Effects, including but not limited to haze, lasers, pyrotechnics, and strobe lights are allowed in the facility. All special effects must be approved in advance by Fishers Event Center Event Contact.

Pyrotechnics

Permits and demonstrations are required by the Fishers Fire Marshal’s office for pyrotechnic displays. To obtain a permit, you must contact Fisher’s Fire Marshal’s Office at (317)232-2222. Pyrotechnics demonstrated will be schedule through your Event Contact. A shooter must be onsite that is licenses in the state of Indiana. If a show does not have a local licensed shooter, one will be obtained at the licensee’s expense. (Local Shoot Contact)

Confetti

There is a \$500 per performance fee for the use of confetti.

Gas Rentals

All rentals of gas needed for special effects or other productions needs can be arranged through your Fishers Event Center Event Contact. Airgas provides all gases. Propane canisters can be no larger than 5 lbs. unless given approval from the Fire Marshal for up to 20 lbs.

Fire Extinguishers

Notify your Fishers Event Center Event Contact if fire extinguishers are needed. They can be rented.

LIGHTING

Lighting

4 spotlights. (8) Spotlight locations include:

- 4 back middle of room.
- 2 back corners (one left, one right).
- 2 center of room (one left, one right).

Spotlight Specs

4 - Canto USA - XLED00020 Aurora X1 Followspot Base Body, 90 CRI,
6000K (Includes LED Engine, Gel Changer, Tripod, & NEMA5-15 Power Cable)

OTHER EVENT CENTER CONFIGURATIONS

Basketball Floor

120' X 60' Maple Hardwood Portable Floor

Basketball Standards will be available.

Volleyball Floor

60' X 30' Teraflex

Arena Football Turf

200' X 85'

ADDITIONAL EQUIPMENT

Rental Services

Markey's Audio Visual | AV Rentals | www.markeys.com

Mid America Sound Corporation | Sound & Lights | www.midamericasound.com

Jonas Productions | Backline | www.jonasproductions.com

Indianapolis Stage Sales & Rentals | www.indystage.com

Sunbelt | Equipment & Tool Rentals | www.sunbeltrentals.com

MacAlister | Equipment & Tool Rentals | www.macallisterrentals.com

CATERING

TOUR CATERING

Dining Area

The catering dining area is located on the 2nd level of the building, directly above the BOH (Back of House) and loading dock on the 1st level. You can access the dining area via the service elevator on the west side of the loading dock.

If you require specific arrangements or equipment in this area, please contact your Fishers Event Center representative for further detail.

In-House Catering

For your event, we proudly offer our in-house catering team, which partners with many outstanding local suppliers to provide top-quality, fresh ingredients. Our experienced staff is committed to delivering excellent food and service while supporting local businesses. We also take pride in incorporating sustainable practices, focuses on minimizing waste and using eco-friendly products whenever possible.

BUILDING INFORMATON

TICKETING OFFICE (BOX OFFICE)

The Ticketing Office is located off 11000 Stockdale St, directly North by the Main Entrance. Another reference point would be considered next to the Team store.

CONTACT INFORMATION

Ticket Office Manager – Kristi Armstrong – karmstrong@asmfishers.com

MERCHANDISE

There are limited locations available for merchandise to be sold. Main Merchandise Stands will be located in the Food Court (NW Corner: Level 1), Retail store in front of the doors (NE Corner: Level 1), and Right beside the Bar/Club on Level 2 (North). Arrangements can be made if additional stands are needed. For more merchandise information please contact (Karen Ezel – karenezell0114@gmail.com & Ryan Hague – rhague@asmfishers.com)

The Fishers Event Center event contact must be notified of any event sponsors or partners in advance.

SPONSORSHIP

If you have any sponsorships related needs from the building, please get in contact with our Director of Marketing Anne Clendenin (aclendenin@asmfishers.com) for approval and set up needs. Examples of these sponsorship-related needs would include but not limited to, activations on the concourse, giveaways, signage, and anything else sponsorship related.

SAFETY & SECURITY

BUILDING SECURITY

Building Security has been allocated to Andy Frain to always monitor the premises. The 24/7 security office is located in the Back of House area near the loading docks. The office number is TBD. Please get in touch with your event contact.

CROWD MANAGEMENT STAFFING

Fishers Event Center reserves the exclusive right to hire, assign and direct Event Security, Guest Relations, and Police for events conducted on our grounds. All requests for security will be arranged by your Fishers Event Center event contact.

Guest Relations

Guest Relations role consists of ticket taking, ushering, and assisting guests by answering questions and providing directions throughout the building.

Event Security

Event Security conducts bag searches and operates x-ray screening technology and/or walk-through metal detectors; secures entrance, back of house, floor, and stage across.

Police

Off-duty Fishers Police Officers. K9 Sweeps and bomb technicians are available upon request.

MEDICAL STAFFING

First Aid facilities are located on Level 1 outside of section 111, near the East Entrance just before the entrance into the Bunker Suites and premium Club.

Heartland (EMT)

Building EMT services can be scheduled for load-in and load-out and for any other specific tour request. For a specific request it will be billed back to the client.

EMERGENCY MEDICAL SERVICES-AUTHORITY (EMSA)

Building EMSA services can be scheduled for load-in and load-out and for any other specific tour request. For a specific request it will be billed back to the client.

LOCAL AREA

HOTELS & LODGING

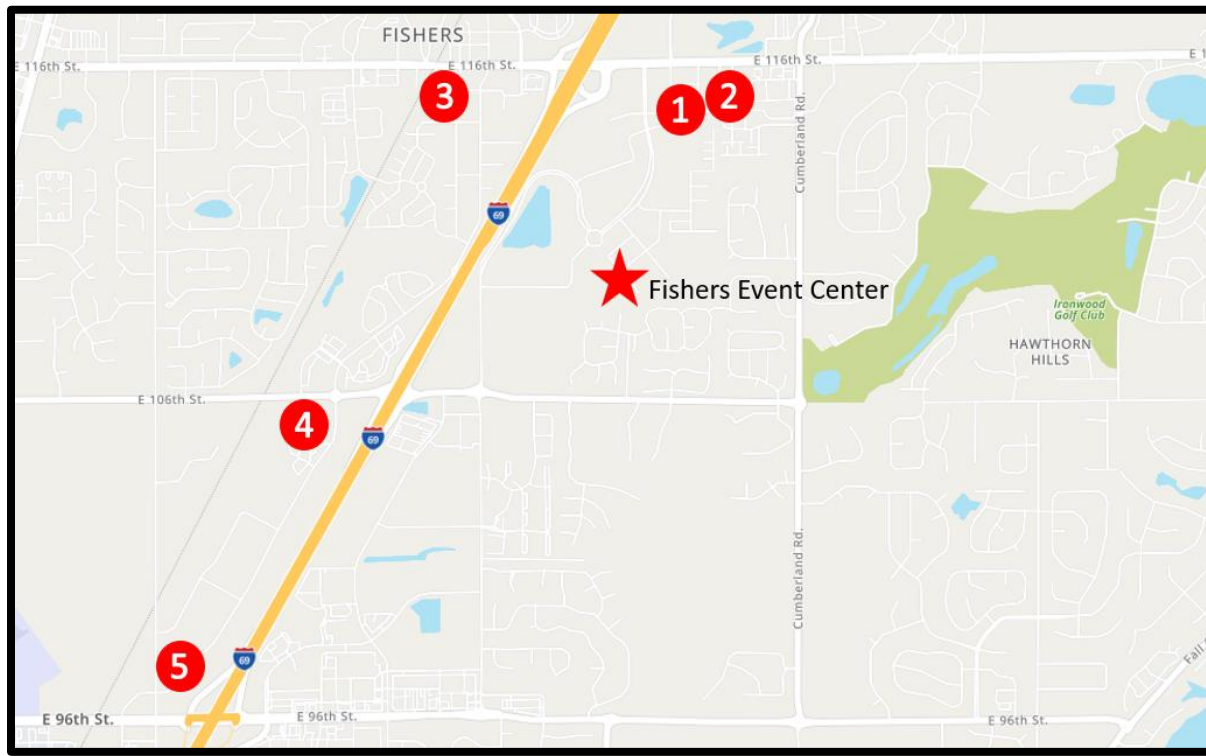

Use the hotel links below for discounted rates offered exclusively to Fishers Event Center Guests

1. [Hyatt Place Indianapolis-Fishers](#)
[Hyatt House Indianapolis- Fishers](#)
 - Leisure group bookings: Kim Lewis | 317-516-5445 | kewis@dunnhospitality.com
 - Corporate group Bookings: Susan Miller | smiller@dunnhospitality.com
 - Free breakfast: Yes | Bus parking: Yes | Number of rooms: 211
2. [Courtyard Marriott Indianapolis Fishers](#)
 - Leisure group bookings: Kim Lewis | 317-516-5445 | kewis@dunnhospitality.com
 - Corporate group Bookings: Lori Sterrett | 317-558-7019 | lsterrett@dunnhospitality.com
 - Free breakfast: No | Bus parking: Yes | Number of rooms: 145
3. [Hotel Nickel Plate Fishers](#)
 - Group Bookings: Mandy Leverenz | 317-284-7085 | mleverenz@dorahotelco.com
 - Free breakfast: No | Bus parking: Yes | Number of rooms: 116
4. [Fairfield by Marriott](#)
 - Group bookings: Brooke Wyatt | 317-567-6996 | bwyatt@dorahg.com
 - Free breakfast: Yes | Bus parking: Yes | Number of rooms: 99
5. [Springhill Suites](#)
 - Group Bookings: Ceira Estrada | 317-284-8905 | ceira.estrada@hbmhotels.com
 - Individual bookings: Amy Alston | 317-284-8902 | amy.alston@hbmhotels.com
 - Free breakfast: Yes | Bus parking: Yes | Number of rooms: 13

NEARBY FOOD OPTIONS

Coffee

Starbucks | 9001 E 116th St, Fishers, IN 46038 | 317-849-3681 | [directions](#)

Java House | 8789 North St, Fishers, IN 46038 | 317-537-7870 | [directions](#)

Pizza

Puccini's Pizza Pasta | 8993 E 116th St, Fishers, IN 46038 | 317- 579-0572 | [directions](#)

I Tre Mori | 8220 E 106th St Ste 200, Indianapolis, IN 46256 | 317-436-8739 | [directions](#)

Sandwiches

Chicken Salad Chick | 11545 IKEA Wy Suite 600, Fishers, IN 46037 | 463-234-1500 | [directions](#)

Portillo's | 9201 E 116th St, Fishers, IN 46037 | 317-588-1111 | [directions](#)

Tacos

Torchy's Tacos | 11595 Whistle Dr Suite 101-A, Fishers, IN 46037 | 317-537-0914 | [directions](#)

Gordito's Rust Belt Tacos & Tortas | 9713 District N Dr Suite #1210, Fishers, IN 46037 | [directions](#)

Healthy Options

Sweetgreen | 9711 E 116th St #300, Fishers, IN 46037 | 463-220-3451 | [directions](#)

Tropical Smoothie Café | 11545 IKEA Wy Suite 620, Fishers, IN 46037 | 317-288-0585 | [directions](#)

Upscale

1933 Lounge by St. Elmo | 9707 District N Dr Suite 1120, Fishers, IN 46037 | 317-758-1933 | [directions](#)

The HC Tavern + Kitchen | 9709 E 116th St, Fishers, IN 46037 | 317-530-4242 | [directions](#)

Late Night Options

Havana Cigar Lounge | 9707 District N Dr Suite 1110, Fishers, IN 46037 | 317-597-7777 | [directions](#)

Chatham Tap | 8211 E 116th St #120, Fishers, IN 46038 | 317-845-1090 | [directions](#)

TRANSPORTATION

Airports

Indianapolis International Airport

- 7800 Col. H. Weir Cook Memorial Dr., Indianapolis, IN 46241
- 317-487-7243

Indianapolis Executive Airport

- 11329 IN-32, Zionsville, IN 46077
- 317-769-4487

Air Charters

- Jet Linx 317-244-7200
- Wise Jets 317-397-0180
- Jet Access 561-283-1214

Car Rentals

Enterprise | 317-567-2307 | 12912 Ford Dr. Fishers, IN 46038

IN CASE OF AN EMERGENCY

Fishers Police Department | Emergency 9-1-1 | Non-Emergency 317-773-1282

Fishers Fire Department | Emergency 9-1-1 | Non-Emergency 317-846-2525

Riverview Health Emergency Room & Urgent Care | 9690 E 116th St, Fishers, IN 46037 | 317-214-5750

MedCheck Fishers | 8890 E 116th St Ste 130, Fishers, IN 46038 | 317-621-7030

Level 1 Trauma 1 Hospital

- IU Health Methodist Hospital | 1701 N. Senate Ave., Indianapolis, IN 46202 | 317-962-2000
- Ascension St. Vincent Hospital | 2001 W. 86th St., Indianapolis, IN 46260 | 317-338-2345



ADDITIONAL RESOURCES

House Curtain

- Runs 120' long and 40' down.

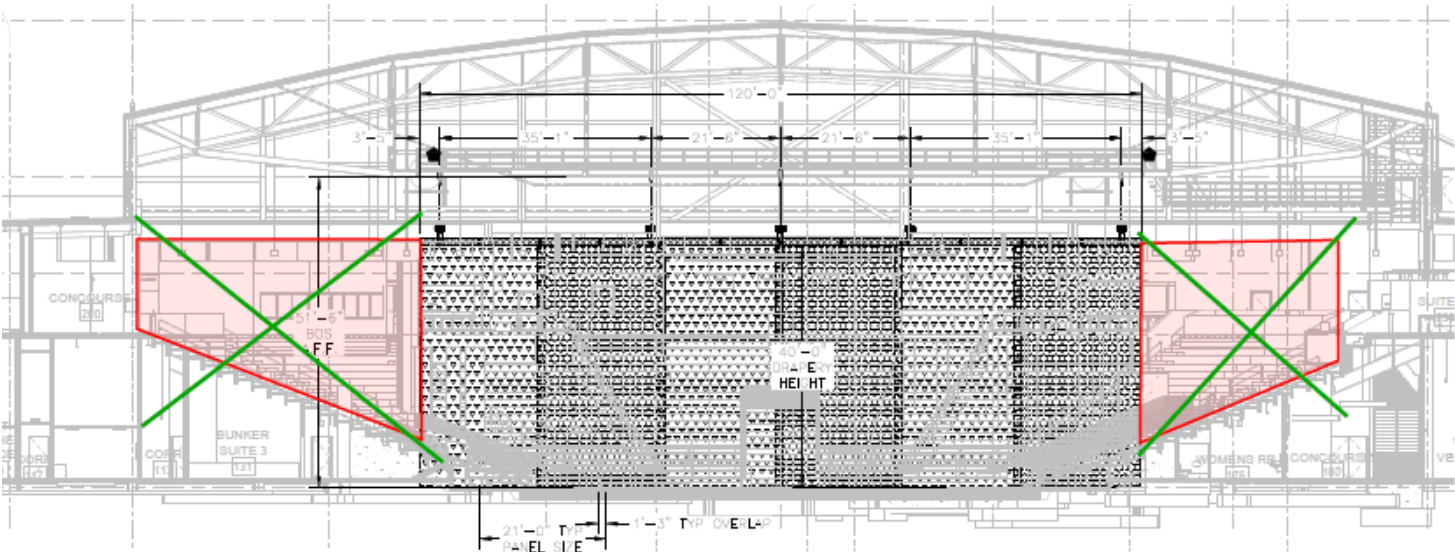
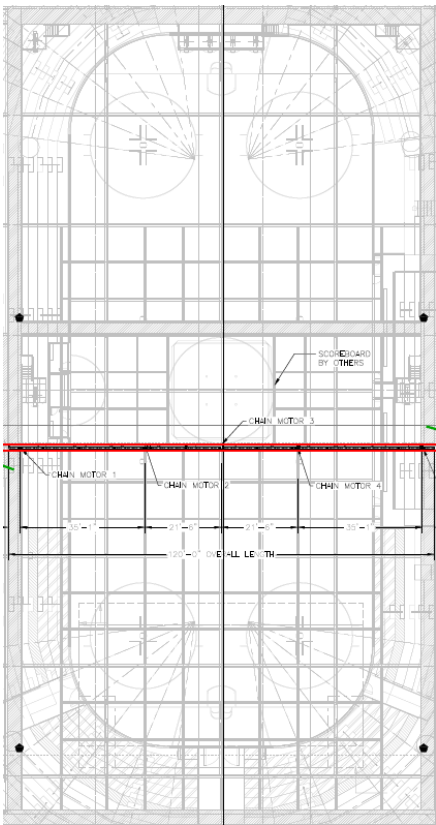
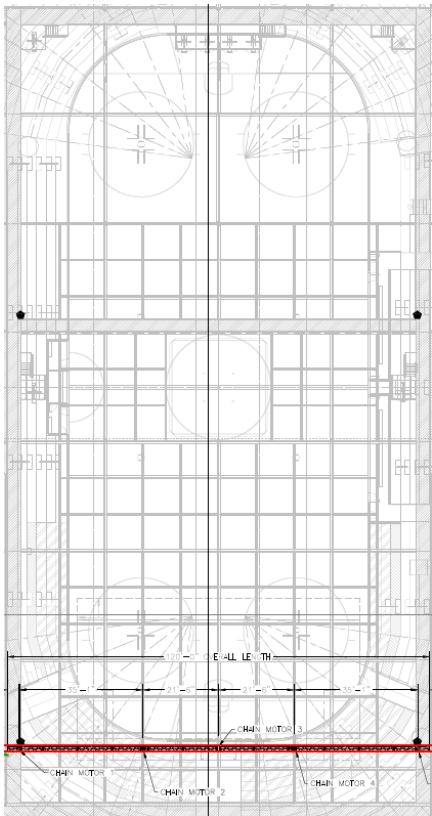

1 ELEVATION VIEW - HALF HOUSE
Scale: 1/16" = 1'-0"

ADDITIONAL RESOURCES

Cameras

Locations

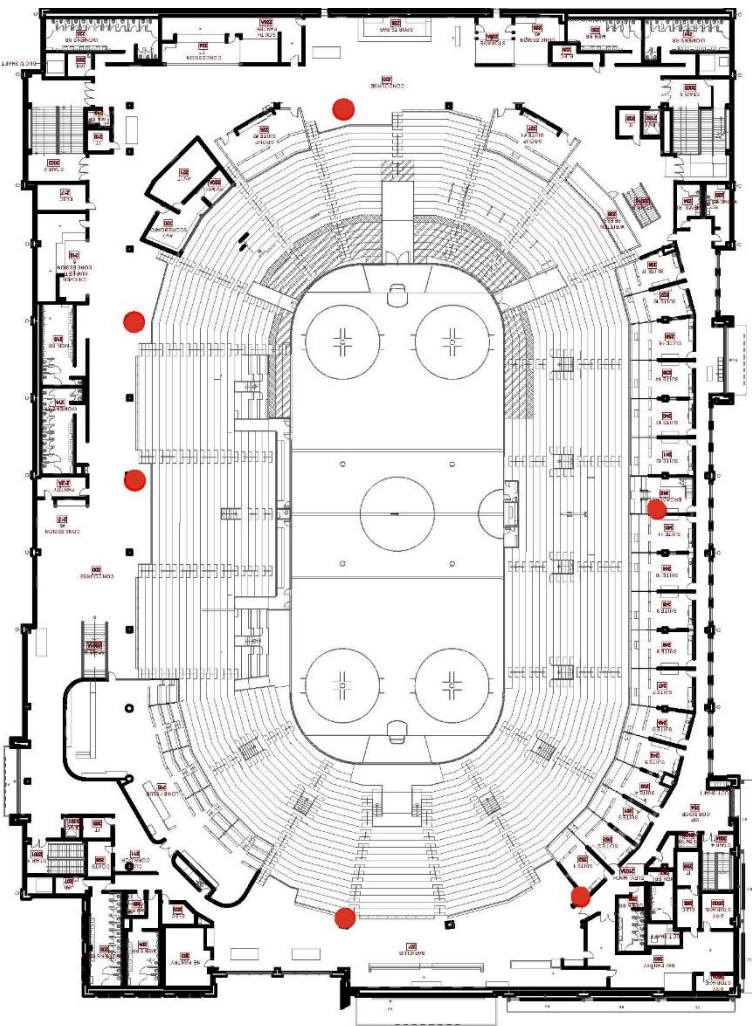
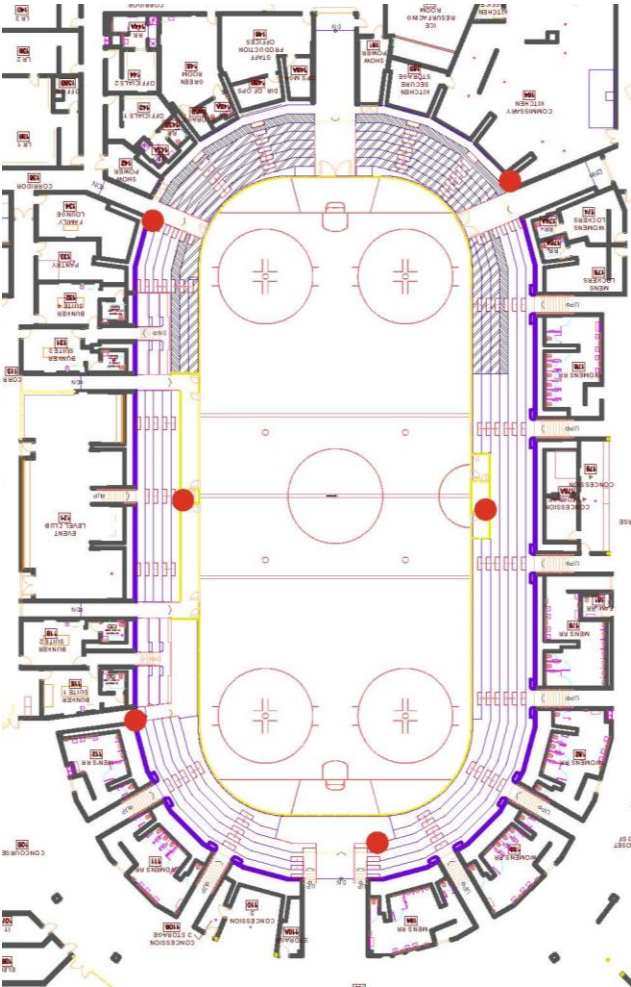

ADDITIONAL RESOURCES

FLOOR LAYOUTS

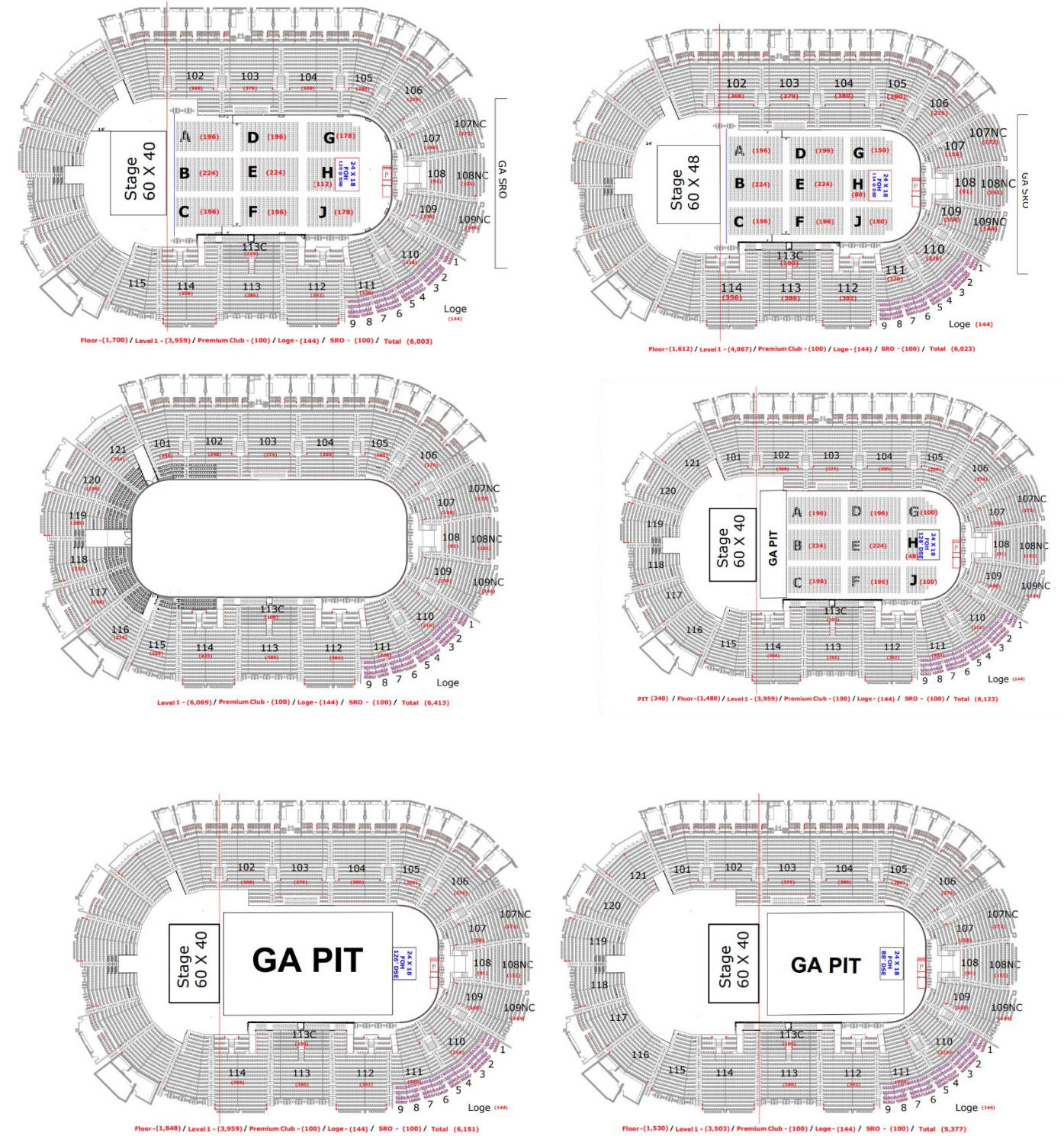

ADDITIONAL RESOURCES

FLOOR LAYOUT

